

4-13-17 525



TRAFFIC CRASH REPORT

LOCAL REPORT NUMBER*	CRASH SEVERITY	HIT/SKIP
17 MPD 0601	3 1-FATAL 2-INJURY 3-PDO	<input type="checkbox"/> 1-SOLVED <input type="checkbox"/> 2-UNSOLVED

LOCAL INFORMATION 17MPD0601		REPORTING AGENCY NCIC*	REPORTING AGENCY NAME*	NUMBER OF UNITS	UNIT IN ERROR
<input type="checkbox"/> PHOTOS TAKEN <input type="checkbox"/> OH-2 <input type="checkbox"/> OH-1P <input type="checkbox"/> OH-3 <input type="checkbox"/> OTHER	<input type="checkbox"/> PDO UNDER STATE REPORTABLE DOLLAR AMOUNT	03801	Millersburg Police Department	2	99 98-ANNUAL 99-UNKNOWN

COUNTY*	<input type="checkbox"/> CITY* <input checked="" type="checkbox"/> VILLAGE* <input type="checkbox"/> TOWNSHIP*	CITY, VILLAGE, TOWNSHIP*	CRASH DATE*	TIME OF CRASH	DAY OF WEEK
Holmes	Millersburg	Millersburg	04/11/2017	1723	Tue

DEGREES/MINUTES/SECONDS	DECIMAL DEGREES
LATITUDE 40:33:00.50	LONGITUDE 81:55:06.60

ROADWAY DIVISION	DIVIDED LANE DIRECTION OF TRAVEL	NUMBER OF THRU LANES	ROAD TYPES OR MILEPOST
<input type="checkbox"/> DIVIDED <input checked="" type="checkbox"/> UNDIVIDED	<input type="checkbox"/> N-NORTHBOUND <input type="checkbox"/> S-SOUTHBOUND	2	AL-ALLEY CR-CIRCLE HE-HEIGHTS MP-MILEPOST PL-PLACE ST-STREET WA-WAY AV-AVENUE CT-COURT HW-HIGHWAY PK-PARKWAY RD-ROAD TE-TERRACE BL-BOULEVARD DR-DRIVE LA-LANE PI-PIKE SQ-SQUARE TL-TRAIL

LOCATION ROUTE NUMBER	LOC PREFIX	LOCATION ROAD NAME	LOCATION ROAD TYPE	ROUTE TYPES
Washington	S	Washington	ST	IR-INTERSTATE ROUTE (INC. TURNPIKE) US-US ROUTE CR-NUMBERED COUNTY ROUTE SR-STATE ROUTE TR-NUMBERED TOWNSHIP ROUTE

DISTANCE FROM REFERENCE	DIR FROM REF	REFERENCE ROUTE	REFERENCE ROUTE NUMBER	REF PREFIX	REFERENCE NAME (ROAD, MILEPOST, HOUSE #)	REFERENCE ROAD TYPE
0	N,S,E,W	Washington	01	S	Deetz	ST

REFERENCE POINT USED	CRASH LOCATION	LOCATION OF FIRST HARMFUL EVENT
1-INTERSECTION 2-MILE POST 3-HOUSE NUMBER	01 01 02-FOUR-WAY INTERSECTION 03-T-INTERSECTION 04-Y-INTERSECTION 05-TRAFFIC CIRCLE/ ROUNDABOUT 06-FIVE-POINT, OR MORE 07-ON RAMP 08-OFF RAMP 09-CROSSOVER 10-DRIVEWAY ALLEY ACCESS 11-RAILWAY GRADE CROSSING 12-SHARED-USE PATHS OR TRAILS 99-UNKNOWN	1 1-ON ROADWAY 2-ON SHOULDER 3-IN MEDIAN 4-ON ROADSIDE 5-ON GORE 6-OUTSIDE TRAFFICWAY 9-UNKNOWN

ROAD CONTOUR	ROAD CONDITIONS
2 1-STRAIGHT LEVEL 2-STRAIGHT GRADE 3-CURVE LEVEL 4-CURVE GRADE 9-UNKNOWN	01 PRIMARY SECONDARY 01-DRY 02-WET 03-SNOW 04-ICE 05-SAND, MUD, DIRT, OIL, GRAVEL 06-WATER (STANDING, MOVING) 07-SLUSH 08-DEBRIS* 09-RUT, HOLES, BUMPS, UNEVEN PAVEMENT* 10-OTHER 99-UNKNOWN

MANNER OF CRASH COLLISION/IMPACT	WEATHER
8 1-NOT COLLISION BETWEEN TWO MOTOR VEHICLES IN TRANSPORT 2-REAR-END 3-HEAD-ON 4-REAR-TO-REAR 5-BACKING 6-ANGLE 7-SIDESWIPE, SAME DIRECTION 8-SIDESWIPE, OPPOSITE DIRECTION 9-UNKNOWN	2 1-CLEAR 2-CLOUDY 3-FOG, SMOG, SMOKE 4-RAIN 5-SLEET, HAIL 6-SNOW 7-SEVERE CROSSWINDS 8-BLOWING SAND, SOIL, DIRT, SNOW 9-OTHER/UNKNOWN

ROAD SURFACE	LIGHT CONDITIONS	SCHOOL BUS RELATED
2 1-CONCRETE 2-BLACKTOP, BITUMINOUS, ASPHALT 3-BRICK/BLOCK 4-SLAG, GRAVEL, STONE 5-DIRT 6-OTHER	1 PRIMARY SECONDARY 1-DAYLIGHT 2-DAWN 3-DUSK 4-DARK-LIGHTED ROADWAY 5-DARK-ROADWAY NOT LIGHTED 6-DARK-UNKNOWN ROADWAY LIGHTING 7-GLARE* 8-OTHER	<input type="checkbox"/> SCHOOL BUS RELATED <input type="checkbox"/> YES, SCHOOL BUS DIRECTLY INVOLVED <input type="checkbox"/> YES, SCHOOL BUS INDIRECTLY INVOLVED

WORK ZONE RELATED	TYPE OF WORK ZONE	LOCATION OF CRASH IN WORK ZONE
<input type="checkbox"/> WORKERS PRESENT <input type="checkbox"/> LAW ENFORCEMENT PRESENT (OFFICER/VEHICLE) <input type="checkbox"/> LAW ENFORCEMENT PRESENT (VEHICLE ONLY)	<input type="checkbox"/> 1-LANE CLOSURE <input type="checkbox"/> 2-LANE SHIFT/CROSSOVER <input type="checkbox"/> 3-WORK ON SHOULDER OR MEDIAN 4-INTERMITTENT OR MOVING WORK 5-OTHER	<input type="checkbox"/> 1-BEFORE THE FIRST WORK ZONE WARNING SIGN <input type="checkbox"/> 2-ADVANCE WARNING AREA <input type="checkbox"/> 3-TRANSITION AREA 4-ACTIVITY AREA 5-TERMINATION AREA

NARRATIVE
Unit 01 southbound on S Washington St while unit 02 was northbound on S Washington St. Unit 01 stated that she thought she was over far enough without hitting the parked cars and unit 02 stated she thought she was over far enough on the curb. Both units struck mirrors causing unit 02 mirror glass to pop off and fall into the vehicle. Unit 01 had minor scratches.

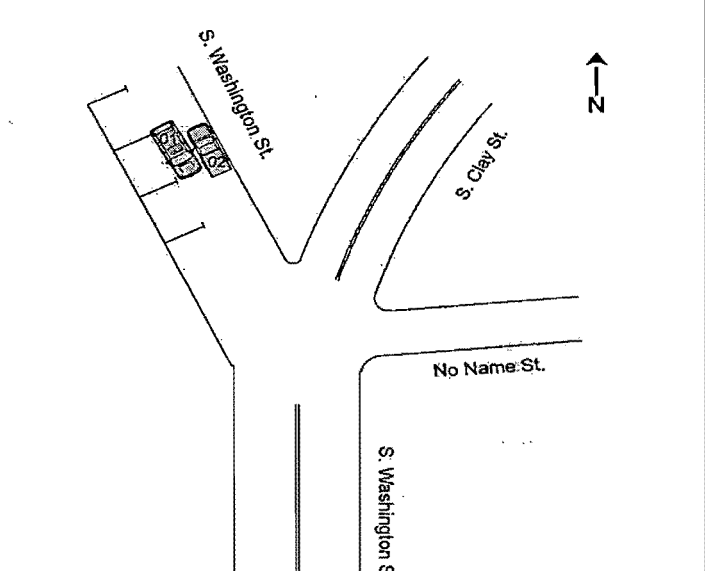

REPORT TAKEN BY	<input type="checkbox"/> SUPPLEMENT (CORRECTION OR ADDITION TO AN EXISTING REPORT SENT TO ODPS)					
<input checked="" type="checkbox"/> POLICE AGENCY <input type="checkbox"/> MOTORIST						
DATE CRASH REPORTED	TIME CRASH REPORTED	DISPATCH TIME	ARRIVAL TIME	TIME CLEARED	OTHER INVESTIGATION TIME	TOTAL MINUTES
04/11/2017	1725	1732	1736	1748	20	36
OFFICER'S NAME*	OFFICER'S BADGE NUMBER	CHECKED BY				
Genet, Stephanie	107					



UNIT

LOCAL REPORT NUMBER

17 MPD 0601

UNIT NUMBER 1	OWNER NAME: LAST, FIRST, MIDDLE (<input type="checkbox"/> SAME AS DRIVER) Chase, Brian, J	OWNER PHONE NUMBER	DAMAGE SCALE 2	DAMAGE AREA FRONT
OWNER ADDRESS: CITY, STATE, ZIP (<input type="checkbox"/> SAME AS DRIVER) 1817 SR 83 Unit 478, Millersburg, OH, 44654			1 - NONE	
LP STATE OH	LICENSE PLATE NUMBER FIB2156	VEHICLE IDENTIFICATION NUMBER 1FMJU2A55BEF07296	2 - MINOR	
VEHICLE YEAR 2011	VEHICLE MAKE Ford	VEHICLE MODEL Expedition	3 - FUNCTIONAL	
PROOF OF INSURANCE SHOWN <input checked="" type="checkbox"/>	INSURANCE COMPANY Allstate	POLICY NUMBER 980424676	4 - DISABLING	
CARRIER NAME, ADDRESS, CITY, STATE, ZIP			9 - UNKNOWN	
CARRIER PHONE				
US DOT	VEHICLE WEIGHT GVWR/GCWR <input type="checkbox"/> 1 - LESS THAN OR EQUAL TO 10K LBS <input type="checkbox"/> 2 - 10,001 TO 26,000K LBS <input type="checkbox"/> 3 - MORE THAN 26,000K LBS.	CARGO BODY TYPE 01 01 - NO CARGO BODY TYPE/NOT APPLICABLE 02 - BUS/VAN (9-15 SEATS, INC DRIVER) 03 - BUS (16+ SEATS, INC DRIVER) 04 - VEHICLE TOWING ANOTHER VEHICLE 05 - LOGGING 06 - INTERMODAL CONTAINER CHASSIS 07 - CARGO VAN/ENCLOSED BOX 08 - GRAIN, CHIPS, GRAVEL	TRAFFICWAY DESCRIPTION 1 1 - TWO-WAY, NOT DIVIDED 2 - TWO-WAY, NOT DIVIDED, CONTINUOUS LEFT TURN LANE 3 - TWO-WAY, DIVIDED, UNPROTECTED (PAINTED OR GRASS >4FT) MEDIAN 4 - TWO-WAY, DIVIDED, POSITIVE MEDIAN BARRIER 5 - ONE-WAY TRAFFICWAY <input type="checkbox"/> HIT / SKIP UNIT	
HM PLACARD ID NO.	HAZARDOUS MATERIAL RELATED <input type="checkbox"/>	09 - POLE 10 - CARGO TANK 11 - FLAT BED 12 - DUMP 13 - CONCRETE MIXER 14 - AUTO TRANSPORTER 15 - GARBAGE/REFUSE 99 - OTHER/UNKNOWN		
HM CLASS NUMBER		01 - SUB-COMPACT 02 - COMPACT 03 - MID SIZE 04 - FULL SIZE 05 - MINIVAN 06 - SPORT UTILITY VEHICLE 07 - PICKUP 08 - VAN 09 - MOTORCYCLE 10 - MOTORIZED BICYCLE 11 - SNOWMOBILE/ATV 12 - OTHER PASSENGER VEHICLE		
NON-MOTORIST LOCATION PRIOR TO IMPACT <input type="checkbox"/>	TYPE OF USE 1 1 - PERSONAL 2 - COMMERCIAL 3 - GOVERNMENT <input type="checkbox"/> IN EMERGENCY RESPONSE	UNIT TYPE 06	MED HEAVY TRUCKS OR COMBO UNITS > 10K LBS BUS/VAN/LIMO (9 OR MORE INCLUDING DRIVER) 13 - SINGLE UNIT TRUCK OR VAN 2AXLE, 6 TIRES 14 - SINGLE UNIT TRUCK; 3+ AXLES 15 - SINGLE UNIT TRUCK/TRAILER 16 - TRUCK/TRACTOR (BOBTAL) 17 - TRACTOR/SEMI-TRAILER 18 - TRACTOR/DOUBLE 19 - TRACTOR/TRIPLES 20 - OTHER MED/HEAVY VEHICLE	21 - BUS/VAN (9-15 SEATS, INC DRIVER) 22 - BUS (16+ SEATS, INC DRIVER) NON-MOTORIST 23 - ANIMAL WITH RIDER 24 - ANIMAL WITH BUGGY, WAGON, SURREY 25 - BICYCLE/PEDALCYCLIST 26 - PEDESTRIAN/SKATER 27 - OTHER NON-MOTORIST
SPECIAL FUNCTION 01	01 - NONE 02 - TAXI 03 - RENTAL TRUCK (OVER 10K LBS) 04 - BUS - SCHOOL (PUBLIC OR PRIVATE) 05 - BUS - TRANSIT 06 - BUS - CHARTER 07 - BUS - SHUTTLE 08 - BUS - OTHER	09 - AMBULANCE 10 - FIRE 11 - HIGHWAY/MAINTENANCE 12 - MILITARY 13 - POLICE 14 - PUBLIC UTILITY 15 - OTHER GOVERNMENT 16 - CONSTRUCTION EQUIP.	MOST DAMAGED AREA 09 01 - NONE 02 - CENTER FRONT 03 - RIGHT FRONT 04 - RIGHT SIDE 05 - RIGHT REAR 06 - REAR CENTER 07 - LEFT REAR	ACTION 5 1 - NON-CONTACT 2 - NON-COLLISION 3 - STRIKING 4 - STRUCK 5 - STRIKING/STRUCK 9 - UNKNOWN
PRE-CRASH ACTIONS 01	MOTORIST 01 - STRAIGHT AHEAD 02 - BACKING 03 - CHANGING LANES 04 - OVERTAKING/PASSING 05 - MAKING RIGHT TURN 06 - MAKING LEFT TURN	07 - MAKING U-TURN 08 - ENTERING TRAFFIC LANE 09 - LEAVING TRAFFIC LANE 10 - PARKED 11 - SLOWING OR STOPPED IN TRAFFIC 12 - DRIVERLESS	NON-MOTORIST 13 - NEGOTIATING A CURVE 14 - OTHER MOTORIST ACTION 15 - ENTERING OR CROSSING SPECIFIED LOCATION 16 - WALKING, RUNNING, JOGGING, PLAYING, CYCLING 17 - WORKING 18 - PUSHING VEHICLE 19 - APPROACHING OR LEAVING VEHICLE 20 - STANDING	21 - OTHER NON-MOTORIST ACTION
CONTRIBUTING CIRCUMSTANCE PRIMARY 08	MOTORIST 01 - NONE 02 - FAILURE TO YIELD 03 - RAN RED LIGHT 04 - RAN STOP SIGN 05 - EXCEEDED SPEED LIMIT 06 - UNSAFE SPEED 07 - IMPROPER TURN 08 - LEFT OF CENTER 09 - FOLLOWED TOO CLOSELY/ACDA 10 - IMPROPER LANE CHANGE /PASSING/OFF ROAD	11 - IMPROPER BACKING 12 - IMPROPER START FROM PARKED POSITION 13 - STOPPED OR PARKED ILLEGALLY 14 - OPERATING VEHICLE IN NEGLIGENT MANNER 15 - SWERING TO AVOID (DUE TO EXTERNAL CONDITIONS) 16 - WRONG SIDE/WRONG WAY 17 - FAILURE TO CONTROL 18 - VISION OBSTRUCTION 19 - OPERATING DEFECTIVE EQUIPMENT 20 - LOAD SHIFTING/FALLING/SPILLING 21 - OTHER IMPROPER ACTION	VEHICLE DEFECTS <input type="checkbox"/>	01 - TURN SIGNALS 02 - HEAD LAMPS 03 - TAIL LAMPS 04 - BRAKES 05 - STEERING 06 - TIRE BLOWOUT 07 - WORN OR SUNK TIRES 08 - TRAILER EQUIPMENT DEFECTIVE 09 - MOTOR TROUBLE 10 - DISABLED FROM PRIOR ACCIDENT 11 - OTHER DEFECTS
NON-MOTORIST 22 - NONE 23 - IMPROPER CROSSING 24 - DARTING 25 - LYING AND/OR ILLEGALLY IN ROADWAY 26 - FAILURE TO YIELD RIGHT OF WAY 27 - NOT VISIBLE (DARK CLOTHING) 28 - INATTENTIVE 29 - FAILURE TO OBEY TRAFFIC SIGNALS/OFFICER 30 - WRONG SIDE OF THE ROAD 31 - OTHER NON-MOTORIST ACTION	VEHICLE DEFECTS <input type="checkbox"/>			
SEQUENCE OF EVENTS 1 20 2 <input type="checkbox"/> 3 <input type="checkbox"/> 4 <input type="checkbox"/> 5 <input type="checkbox"/> 6 <input type="checkbox"/>	FIRST HARMFUL EVENT 1	MOST HARMFUL EVENT 1	NON-COLLISION EVENTS 01 - OVERTURN/ROLLOVER 02 - FIRE/EXPLOSION 03 - IMMERSION 04 - JACKKNIFE 05 - CARGO/EQUIPMENT LOSS OR SHIFT	06 - EQUIPMENT FAILURE (BLOWN TIRE, BRAKE FAILURE, ETC) 07 - SEPARATION OF UNITS 08 - RAN OFF ROAD RIGHT 09 - RAN OFF ROAD LEFT
COLLISION WITH PERSON, VEHICLE OR OBJECT NOT FIXED	14 - PEDESTRIAN 15 - PEDALCYCLE 16 - RAILWAY VEHICLE (TRAIN, ENGINE) 17 - ANIMAL - FARM 18 - ANIMAL - DEER 19 - ANIMAL - OTHER 20 - MOTOR VEHICLE IN TRANSPORT	21 - PARKED MOTOR VEHICLE 22 - WORK ZONE MAINTENANCE EQUIPMENT 23 - STRUCK BY FALLING, SHIFTING CARGO OR ANYTHING SET IN MOTION BY A MOTOR VEHICLE 24 - OTHER MOVABLE OBJECT	25 - IMPACT ATTENUATOR/CRASH CUSHION 26 - BRIDGE OVERHEAD STRUCTURE 27 - BRIDGE PIER OR ABUTMENT 28 - BRIDGE PARAPET 29 - BRIDGE RAIL 30 - GUARDRAIL FACE 31 - GUARDRAIL END 32 - PORTABLE BARRIER	33 - MEDIAN CABLE BARRIER 34 - MEDIAN GUARDRAIL BARRIER 35 - MEDIAN CONCRETE BARRIER 36 - MEDIAN OTHER BARRIER 37 - TRAFFIC SIGN POST 38 - OVERHEAD SIGN POST 39 - LIGHT/LUMINARIES SUPPORT 40 - UTILITY POLE
UNIT SPEED 25	POSTED SPEED 25	TRAFFIC CONTROL 01 01 - NO CONTROLS 02 - STOP SIGN 03 - YIELD SIGN 04 - TRAFFIC SIGNAL 05 - TRAFFIC FLASHERS 06 - SCHOOL ZONE	07 - RAILROAD CROSSBUCKS 08 - RAILROAD FLASHERS 09 - RAILROAD GATES 10 - CONSTRUCTION BARRICADE 11 - PERSON (FLAGGER, OFFICER) 12 - PAVEMENT MARKINGS	13 - CROSSWALK LINES 14 - WALK/DON'T WALK 15 - OTHER 16 - NOT REPORTED
UNIT DIRECTION FROM 1 TO 2	1 - NORTH 2 - SOUTH 3 - EAST 4 - WEST	5 - NORTHEAST 6 - NORTHWEST 7 - SOUTHEAST 8 - SOUTHWEST	9 - UNKNOWN	



UNIT

LOCAL REPORT NUMBER

17 MPD 0601

UNIT NUMBER 2	OWNER NAME: LAST, FIRST, MIDDLE (<input type="checkbox"/> SAME AS DRIVER) Stahl, Kaylee, I	OWNER PHONE NUMBER	DAMAGE SCALE 2	DAMAGE AREA FRONT REAR
OWNER ADDRESS: CITY, STATE, ZIP (<input type="checkbox"/> SAME AS DRIVER) 6631 TR 501, Big Prairie, OH, 44611			1 - NONE	
LP STATE OH	LICENSE PLATE NUMBER FYP9440	VEHICLE IDENTIFICATION NUMBER 5TELU42N58Z500362	2 - MINOR	
VEHICLE YEAR 2008	VEHICLE MAKE Toyota	VEHICLE MODEL Tacoma	3 - FUNCTIONAL	
PROOF OF INSURANCE SHOWN <input checked="" type="checkbox"/>	INSURANCE COMPANY Wayne Mutual	POLICY NUMBER 162549	4 - DISABLING	
CARRIER NAME, ADDRESS, CITY, STATE, ZIP			9 - UNKNOWN	
CARRIER PHONE				

US DOT	VEHICLE WEIGHT GVWR/GCWR <input type="checkbox"/> 1 - LESS THAN OR EQUAL TO 10K LBS <input type="checkbox"/> 2 - 10,001 TO 26,000K LBS <input type="checkbox"/> 3 - MORE THAN 26,000K LBS.	CARGO BODY TYPE 01 01 - NO CARGO BODY TYPE/NOT APPLICABLE 02 - BUS/VAN (9-15 SEATS, INC DRIVER) 03 - BUS (16+ SEATS, INC DRIVER) 04 - VEHICLE TOWING ANOTHER VEHICLE 05 - LOGGING 06 - INTERMODAL CONTAINER CHASSIS 07 - CARGO VAN/ENCLOSED BOX 08 - GRAIN, CHIPS, GRAVEL	TRAFFICWAY DESCRIPTION 1 1 - T WO-WAY, NOT DIVIDED 2 - T WO-WAY, NOT DIVIDED, CONTINUOUS LEFT TURN LANE 3 - T WO-WAY, DIVIDED, UNPROTECTED (PAINTED OR GRASS 4FT.) MEDIA 4 - T WO-WAY, DIVIDED, POSITIVE MEDIAN BARRIER 5 - ONE-WAY TRAFFICWAY <input type="checkbox"/> HIT / SKIP UNIT
HM PLACARD ID NO.	HAZARDOUS MATERIAL RELATED <input type="checkbox"/>		
HM CLASS NUMBER			

NON-MOTORIST LOCATION PRIOR TO IMPACT <input type="checkbox"/> 01 - INTERSECTION - MARKED CROSSWALK 02 - INTERSECTION - NO CROSSWALK 03 - INTERSECTION OTHER 04 - MIDBLOCK - MARKED CROSSWALK 05 - TRAVEL LANE - OTHER LOCATION 06 - BICYCLE LANE 07 - SHOULDER/ROADSIDE 08 - SIDEWALK 09 - MEDIAN CROSSING ISLAND 10 - DRIVEWAY ACCESS 11 - SHARED-USE PATH OR TRAIL 12 - NON-TRAFFICWAY AREA 99 - OTHER/UNKNOWN	TYPE OF USE 1 1 - PERSONAL 2 - COMMERCIAL 3 - GOVERNMENT <input type="checkbox"/> IN EMERGENCY RESPONSE	UNIT TYPE 07 PASSENGER VEHICLES (LESS THAN 9 PASSENGERS) 01 - SUB-COMPACT 02 - COMPACT 03 - MID SIZE 04 - FULL SIZE 05 - MINIVAN 06 - SPORT UTILITY VEHICLE 07 - PICKUP 08 - VAN 09 - MOTORCYCLE 10 - MOTORIZED BICYCLE 11 - SNOWMOBILE/ATV 12 - OTHER PASSENGER VEHICLE	MED/HEAVY TRUCKS OR COMBO UNITS > 10K LBS 13 - SINGLE UNIT TRUCK OR VAN 2AXLE, 6 TIRES 14 - SINGLE UNIT TRUCK; 3+ AXLES 15 - SINGLE UNIT TRUCK / TRAILER 16 - TRUCK/TRACTOR (BOBTAIL) 17 - TRACTOR/SEMI-TRAILER 18 - TRACTOR/DOUBLE 19 - TRACTOR/TRIPLES 20 - OTHER MED/HEAVY VEHICLE	NON-MOTORIST 21 - BUS/VAN (9-15 SEATS, INC DRIVER) 22 - BUS (16+ SEATS, INC DRIVER) 23 - ANIMAL WITH RIDER 24 - ANIMAL WITH BUGGY, WAGON, SURREY 25 - BICYCLE/PEDALCYCLIST 26 - PEDESTRIAN/SKATER 27 - OTHER NON-MOTORIST
<input type="checkbox"/> HAS HM PLACARD				

SPECIAL FUNCTION 01 01 - NONE 02 - TAXI 03 - RENTAL TRUCK (OVER 10K LBS) 04 - BUS - SCHOOL (PUBLIC OR PRIVATE) 05 - BUS - TRANSIT 06 - BUS - CHARTER 07 - BUS - SHUTTLE 08 - BUS - OTHER	09 - AMBULANCE 10 - FIRE 11 - HIGHWAY/MAINTENANCE 12 - MILITARY 13 - POLICE 14 - PUBLIC UTILITY 15 - OTHER GOVERNMENT 16 - CONSTRUCTION EQUIP.	17 - FARM VEHICLE 18 - FARM EQUIPMENT 19 - MOTORHOME 20 - GOLF CART 21 - TRAIN 22 - OTHER (EXPLAIN IN NARRATIVE)	MOST DAMAGED AREA 09 01 - NONE 02 - CENTER FRONT 03 - RIGHT FRONT 04 - RIGHT SIDE 05 - RIGHT REAR 06 - REAR CENTER 07 - LEFT REAR	08 - LEFT SIDE 09 - LEFT FRONT 10 - TOP AND WINDOWS 11 - UNDERCARRIAGE 12 - LOAD/TRAILER 13 - TOTAL (ALL AREAS) 14 - OTHER	ACTION 5 1 - NON-CONTACT 2 - NON-COLLISION 3 - STRIKING 4 - STRUCK 5 - STRIKING/STRUCK 9 - UNKNOWN
--	---	---	--	--	--

PRE-CRASH ACTIONS 01	MOTORIST 01 - STRAIGHT AHEAD 02 - BACKING 03 - CHANGING LANES 04 - OVERTAKING/PASSING 05 - MAKING RIGHT TURN 06 - MAKING LEFT TURN 99 - UNKNOWN	07 - MAKING U-TURN 08 - ENTERING TRAFFIC LANE 09 - LEAVING TRAFFIC LANE 10 - PARKED 11 - SLOWING OR STOPPED IN TRAFFIC 12 - DRIVERLESS	13 - NEGOTIATING A CURVE 14 - OTHER MOTORIST ACTION	NON-MOTORIST 15 - ENTERING OR CROSSING SPECIFIED LOCATION 16 - WALKING, RUNNING, JOGGING, PLAYING, CYCLING 17 - WORKING 18 - PUSHING VEHICLE 19 - APPROACHING OR LEAVING VEHICLE 20 - STANDING 21 - OTHER NON-MOTORIST ACTION
--------------------------------	--	---	--	--

CONTRIBUTING CIRCUMSTANCE PRIMARY 08 01 - NONE 02 - FAILURE TO YIELD 03 - RAN RED LIGHT 04 - RAN STOP SIGN 05 - EXCEEDED SPEED LIMIT 06 - UNSAFE SPEED 07 - IMPROPER TURN 08 - LEFT OF CENTER 09 - FOLLOWED TOO CLOSELY/ACDA 10 - IMPROPER LANE CHANGE PASSING/OFF ROAD	MOTORIST 01 - NONE 02 - FAILURE TO YIELD 03 - RAN RED LIGHT 04 - RAN STOP SIGN 05 - EXCEEDED SPEED LIMIT 06 - UNSAFE SPEED 07 - IMPROPER TURN 08 - LEFT OF CENTER 09 - FOLLOWED TOO CLOSELY/ACDA 10 - IMPROPER LANE CHANGE PASSING/OFF ROAD	11 - IMPROPER BACKING 12 - IMPROPER START FROM PARKED POSITION 13 - STOPPED OR PARKED ILLEGALLY 14 - OPERATING VEHICLE IN NEGLIGENT MANNER 15 - SWERING TO AVOID (DUE TO EXTERNAL CONDITIONS) 16 - WRONG SIDE/WRONG WAY 17 - FAILURE TO CONTROL 18 - VISION OBSTRUCTION 19 - OPERATING DEFECTIVE EQUIPMENT 20 - LOAD SHIFTING/FALLING/SPILLING 21 - OTHER IMPROPER ACTION	NON-MOTORIST 22 - NONE 23 - IMPROPER CROSSING 24 - DARTING 25 - LYING AND/OR ILLEGALLY IN ROADWAY 26 - FAILURE TO YIELD RIGHT OF WAY 27 - NOT VISIBLE (DARK CLOTHING) 28 - INATTENTIVE 29 - FAILURE TO OBEY TRAFFIC SIGNALS / SIGNALS/OFFICER 30 - WRONG SIDE OF THE ROAD 31 - OTHER NON-MOTORIST ACTION	VEHICLE DEFECTS <input type="checkbox"/> 01 - TURN SIGNALS 02 - HEAD LAMPS 03 - TAIL LAMPS 04 - BRAKES 05 - STEERING 06 - TIRE BLOWOUT 07 - WORN OR SLICK TIRES 08 - TRAILER EQUIPMENT DEFECTIVE 09 - MOTOR TROUBLE 10 - DISABLED FROM PRIOR ACCIDENT 11 - OTHER DEFECTS
---	--	---	--	--

SEQUENCE OF EVENTS 1 20 2 <input type="checkbox"/> 3 <input type="checkbox"/> 4 <input type="checkbox"/> 5 <input type="checkbox"/> 6 <input type="checkbox"/> FIRST HARMFUL EVENT 1 MOST HARMFUL EVENT 1	NON-COLLISION EVENTS 01 - OVERTURN/ROLLOVER 02 - FIRE/EXPLOSION 03 - IMMERSION 04 - JACKKNIFE 05 - CARGO/EQUIPMENT LOSS OR SHIFT	06 - EQUIPMENT FAILURE (BLOWN TIRE, BRAKE FAILURE, ETC) 07 - SEPARATION OF UNITS 08 - RAN OFF ROAD RIGHT 09 - RAN OFF ROAD LEFT	10 - CROSS MEDIAN 11 - CROSS CENTER LINE OPPOSITE DIRECTION OF TRAVEL 12 - DOWNHILL RUNAWAY 13 - OTHER NON-COLLISION
--	---	--	--

COLLISION WITH PERSON, VEHICLE OR OBJECT NOT FIXED 14 - PEDESTRIAN 15 - PEDALCYCLE 16 - RAILWAY VEHICLE (TRAIN, ENGINE) 17 - ANIMAL - FARM 18 - ANIMAL - DEER 19 - ANIMAL - OTHER 20 - MOTOR VEHICLE IN TRANSPORT	21 - PARKED MOTOR VEHICLE 22 - WORK ZONE MAINTENANCE EQUIPMENT 23 - STRUCK BY FALLING, SHIFTING CARGO OR ANYTHING SET IN MOTION BY A MOTOR VEHICLE 24 - OTHER MOVABLE OBJECT	COLLISION WITH FIXED OBJECT 25 - IMPACT ATTENUATOR/CRASH CUSHION 26 - BRIDGE OVERHEAD STRUCTURE 27 - BRIDGE PIER OR ABUTMENT 28 - BRIDGE PARAPET 29 - BRIDGE RAIL 30 - GUARDRAIL FACE 31 - GUARDRAIL END 32 - PORTABLE BARRIER	33 - MEDIAN CABLE BARRIER 34 - MEDIAN GUARDRAIL BARRIER 35 - MEDIAN CONCRETE BARRIER 36 - MEDIAN OTHER BARRIER 37 - TRAFFIC SIGN POST 38 - OVERHEAD SIGN POST 39 - LIGHT/LUMINARIES SUPPORT 40 - UTILITY POLE	41 - OTHER POST, POLE OR SUPPORT 42 - CULVERT 43 - CURB 44 - DITCH 45 - EMBANKMENT 46 - FENCE 47 - MAILBOX	48 - TREE 49 - FIRE HYDRANT 50 - WORK ZONE MAINTENANCE EQUIPMENT 51 - WALL, BUILDING, TUNNEL 52 - OTHER FIXED OBJECT
--	---	--	--	--	--

UNIT SPEED 25	POSTED SPEED 25	TRAFFIC CONTROL 01 01 - NO CONTROLS 02 - STOP SIGN 03 - YIELD SIGN 04 - TRAFFIC SIGNAL 05 - TRAFFIC FLASHERS 06 - SCHOOL ZONE	07 - RAILROAD CROSSBUCKS 08 - RAILROAD FLASHERS 09 - RAILROAD GATES 10 - CONSTRUCTION BARRICADE 11 - PERSON (FLAGGER, OFFICER) 12 - PAVEMENT MARKINGS	13 - CROSSWALK LINES 14 - WALK/DONT WALK 15 - OTHER 16 - NOT REPORTED	UNIT DIRECTION FROM 2 TO 1 1 - NORTH 2 - SOUTH 3 - EAST 4 - WEST	5 - NORTHEAST 6 - NORTHWEST 7 - SOUTHEAST 8 - SOUTHWEST 9 - UNKNOWN
-------------------------	---------------------------	---	--	--	---	---



MOTORIST / NON-MOTORIST / OCCUPANT

LOCAL REPORT NUMBER
17 MPD 0601

UNIT NUMBER 1	NAME: LAST, FIRST, MIDDLE Chase, Tina, M	DATE OF BIRTH 07/12/1971	AGE 45	GENDER <input checked="" type="checkbox"/> F F - FEMALE <input type="checkbox"/> M M - MALE
ADDRESS, CITY, STATE, ZIP 1817 SR 83 Unit 478, Millersburg, OH, 44654			CONTACT PHONE - INCLUDE AREA CODE 330-634-0447	
INJURIES <input checked="" type="checkbox"/> 1	INJURED TAKEN BY <input checked="" type="checkbox"/> 1	EMS AGENCY	MEDICAL FACILITY INJURED TAKEN TO	SAFETY EQUIPMENT USED 04
OL STATE OH	OPERATOR LICENSE NUMBER RK456378	OL CLASS <input checked="" type="checkbox"/> 4	No <input type="checkbox"/> VALID DL	M/C <input type="checkbox"/> END
CONDITION <input checked="" type="checkbox"/> 1	ALCOHOL/DRUG SUSPECTED <input checked="" type="checkbox"/> 1	ALCOHOL TEST STATUS <input checked="" type="checkbox"/> 1	ALCOHOL TEST TYPE <input checked="" type="checkbox"/> 1	ALCOHOL TEST VALUE 1
OFFENSE CHARGED (<input type="checkbox"/> LOCAL CODE)	OFFENSE DESCRIPTION	CITATION NUMBER	HANDS-FREE <input type="checkbox"/> DEVICE USED	DRIVER DISTRACTED BY <input checked="" type="checkbox"/> 1

UNIT NUMBER 2	NAME: LAST, FIRST, MIDDLE Stahl, Sarah, Deborah	DATE OF BIRTH 01/07/1996	AGE 21	GENDER <input checked="" type="checkbox"/> F F - FEMALE <input type="checkbox"/> M M - MALE
ADDRESS, CITY, STATE, ZIP 6631 TR 501, Big Prairie, OH, 44611			CONTACT PHONE - INCLUDE AREA CODE 330-317-5716	
INJURIES <input checked="" type="checkbox"/> 1	INJURED TAKEN BY <input checked="" type="checkbox"/> 1	EMS AGENCY	MEDICAL FACILITY INJURED TAKEN TO	SAFETY EQUIPMENT USED 04
OL STATE OH	OPERATOR LICENSE NUMBER TY983229	OL CLASS <input checked="" type="checkbox"/> 4	No <input type="checkbox"/> VALID DL	M/C <input type="checkbox"/> END
CONDITION <input checked="" type="checkbox"/> 1	ALCOHOL/DRUG SUSPECTED <input checked="" type="checkbox"/> 1	ALCOHOL TEST STATUS <input checked="" type="checkbox"/> 1	ALCOHOL TEST TYPE <input checked="" type="checkbox"/> 1	ALCOHOL TEST VALUE 1
OFFENSE CHARGED (<input type="checkbox"/> LOCAL CODE)	OFFENSE DESCRIPTION	CITATION NUMBER	HANDS-FREE <input type="checkbox"/> DEVICE USED	DRIVER DISTRACTED BY <input checked="" type="checkbox"/> 1

INJURIES	INJURED TAKEN BY	SAFETY EQUIPMENT USED	99 - UNKNOWN SAFETY EQUIPMENT
1 - NO INJURY / NONE REPORTED 2 - POSSIBLE 3 - NON-INCAPACITATING 4 - INCAPACITATING 5 - FATAL	1 - NOT TRANSPORTED / TREATED AT SCENE 2 - EMS 3 - POLICE 4 - OTHER 9 - UNKNOWN	MOTORIST 01 - NONE USED - VEHICLE OCCUPANT 02 - SHOULDER BELT ONLY USED 03 - LAP BELT ONLY USED 04 - SHOULDER AND LAP BELT ONLY USED	NON-MOTORIST 05 - CHILD RESTRAINT SYSTEM - FORWARD FACING 06 - CHILD RESTRAINT SYSTEM - REAR FACING 07 - BOOSTER SEAT 08 - HELMET USED 09 - NONE USED 10 - HELMET USED 11 - PROTECTIVE PADS USED (ELBOWS, KNEES, ETC.) 12 - REFLECTIVE COATING 13 - LIGHTING 14 - OTHER
SEATING POSITION			AIR BAG USAGE
01 - FRONT - LEFT SIDE (Motorcycle Driver) 02 - FRONT - MIDDLE 03 - FRONT - RIGHT SIDE 04 - SECOND - LEFT SIDE (Motorcycle Passenger) 05 - SECOND - MIDDLE 06 - SECOND - RIGHT SIDE 07 - THIRD - LEFT SIDE (Motorcycle Side Car) 08 - THIRD - MIDDLE 09 - THIRD - RIGHT SIDE 10 - SLEEPER SECTION OF CAB (TRUCK) 11 - PASSENGER IN OTHER ENCLOSED CARGO AREA (NON-TRAILING UNIT SUCH AS A BUS, PICKUP WITH CAB) 12 - PASSENGER IN UNENCLOSED CARGO AREA 13 - TRAILING UNIT 14 - RIDING ON VEHICLE EXTERIOR (NON-TRAILING UNIT) 15 - NON-MOTORIST 16 - OTHER 99 - UNKNOWN			1 - NOT DEPLOYED 2 - DEPLOYED FRONT 3 - DEPLOYED SIDE 4 - DEPLOYED BOTH FRONT/SIDE 5 - NOT APPLICABLE 9 - DEPLOYMENT UNKNOWN
EJECTION	TRAPPED	OPERATOR LICENSE CLASS	CONDITION
1 - NOT EJECTED 2 - TOTALLY EJECTED 3 - PARTIALLY EJECTED 4 - NOT APPLICABLE	1 - NOT TRAPPED 2 - EXTRICATED BY MECHANICAL MEANS 3 - EXTRICATED BY NON-MECHANICAL MEANS	1 - CLASS A 2 - CLASS B 3 - CLASS C 4 - REGULAR CLASS (PASS. TO) 5 - MC/MOPED ONLY	1 - APPARENTLY NORMAL 2 - PHYSICAL IMPAIRMENT 3 - EMOTION (DEPRESSED, ANGRY, DISTURBED) 4 - ILLNESS 5 - FELL ASLEEP, FAINTED, FATIGUE 6 - UNDER THE INFLUENCE OF MEDICATIONS, DRUGS, ALCOHOL 7 - OTHER
ALCOHOL TEST STATUS	ALCOHOL TEST TYPE	DRUG TEST STATUS	DRUG TEST TYPE
1 - NONE GIVEN 2 - TEST REFUSED 3 - TEST GIVEN, CONTAMINATED SAMPLE/UNUSABLE 4 - TEST GIVEN, RESULTS KNOWN 5 - TEST GIVEN, RESULTS UNKNOWN	1 - NONE 2 - BLOOD 3 - URINE 4 - BREATH 5 - OTHER	1 - NONE GIVEN 2 - TEST REFUSED 3 - TEST GIVEN, CONTAMINATED SAMPLE/UNUSABLE 4 - TEST GIVEN, RESULTS KNOWN 5 - TEST GIVEN, RESULTS UNKNOWN	1 - NONE 2 - BLOOD 3 - URINE 4 - OTHER

ALCOHOL/DRUG SUSPECTED	1 - NONE 2 - YES - ALCOHOL SUSPECTED 3 - YES - HAD NOT IMPAIRED 4 - YES - DRUGS SUSPECTED 5 - YES - ALCOHOL AND DRUGS SUSPECTED
DRIVER DISTRACTED BY	1 - NO DISTRACTION REPORTED 2 - PHONE 3 - TEXTING/EMAILING 4 - ELECTRONIC COMMUNICATION DEVICE 5 - OTHER ELECTRONIC DEVICE (NAVIGATION DEVICE, RADAR, DVD) 6 - OTHER INSIDE THE VEHICLE 7 - EXTERNAL DISTRACTION

UNIT NUMBER 1	NAME: LAST, FIRST, MIDDLE Nicholson, Elen, J	DATE OF BIRTH 11/22/2000	AGE 16	GENDER <input checked="" type="checkbox"/> F F - FEMALE <input type="checkbox"/> M M - MALE
ADDRESS, CITY, STATE, ZIP 5666 Unger Rd, Atwater, OH, 44201			CONTACT PHONE - INCLUDE AREA CODE 330-618-7148	
INJURIES <input checked="" type="checkbox"/> 1	INJURED TAKEN BY <input checked="" type="checkbox"/> 1	EMS AGENCY	MEDICAL FACILITY INJURED TAKEN TO	SAFETY EQUIPMENT USED 04
OL STATE	OPERATOR LICENSE NUMBER	OL CLASS	No <input type="checkbox"/> VALID DL	M/C <input type="checkbox"/> END
CONDITION	ALCOHOL/DRUG SUSPECTED	ALCOHOL TEST STATUS	ALCOHOL TEST TYPE	ALCOHOL TEST VALUE
OFFENSE CHARGED (<input type="checkbox"/> LOCAL CODE)	OFFENSE DESCRIPTION	CITATION NUMBER	HANDS-FREE <input type="checkbox"/> DEVICE USED	DRIVER DISTRACTED BY <input checked="" type="checkbox"/> 1

UNIT NUMBER	NAME: LAST, FIRST, MIDDLE	DATE OF BIRTH	AGE	GENDER <input type="checkbox"/> F F - FEMALE <input type="checkbox"/> M M - MALE
ADDRESS, CITY, STATE, ZIP			CONTACT PHONE - INCLUDE AREA CODE	
INJURIES <input type="checkbox"/>	INJURED TAKEN BY <input type="checkbox"/>	EMS AGENCY	MEDICAL FACILITY INJURED TAKEN TO	SAFETY EQUIPMENT USED DOT COMPLIANT MOTORCYCLE HELMET
OL STATE	OPERATOR LICENSE NUMBER	OL CLASS	No <input type="checkbox"/> VALID DL	M/C <input type="checkbox"/> END
CONDITION	ALCOHOL/DRUG SUSPECTED	ALCOHOL TEST STATUS	ALCOHOL TEST TYPE	ALCOHOL TEST VALUE
OFFENSE CHARGED (<input type="checkbox"/> LOCAL CODE)	OFFENSE DESCRIPTION	CITATION NUMBER	HANDS-FREE <input type="checkbox"/> DEVICE USED	DRIVER DISTRACTED BY <input type="checkbox"/>